

DATED THIS TWENTY-SIXTH DAY OF FEBRUARY 2010

LEEDS CITY COUNCIL
(TRAFFIC REGULATION) (WAITING RESTRICTIONS)
(NO.W31) ORDER
2008

GIPSY LANE BEESTON LEEDS

NO STOPPING 8:00AM TO 9:00AM AND 2:30PM TO 3:30PM MONDAY TO FRIDAY
INCLUSIVE ON SCHOOL ENTRANCE MARKINGS

NICOLÉ JACKSON
Assistant Chief Executive (Corporate Governance)
Civic Hall
LEEDS
LS1 1UR

A76/RAH/871985

**LEEDS CITY COUNCIL
(TRAFFIC REGULATION) (WAITING RESTRICTIONS)
(NO.W31) ORDER
2008**

GIPSY LANE BEESTON LEEDS

**NO STOPPING 8:00AM TO 9:00AM AND 2:30PM TO 3:30PM MONDAY TO FRIDAY
INCLUSIVE ON SCHOOL ENTRANCE MARKINGS**

Leeds City Council (hereinafter referred to as "the Council") in exercise of the powers contained in Sections 1 and 2 of the Road Traffic Regulation Act 1984 (hereinafter referred to as "the 1984 Act") and in pursuance of the powers contained in Section 73 and Schedule 7 of the Traffic Management Act 2004 and of all other powers so enabling and after consultation with the Chief Officer of Police in accordance with Part III of Schedule 9 to the 1984 Act and with those persons and organisations specified in the Local Authorities' Traffic Orders (Procedure) (England and Wales) Regulations 1996 hereby makes the following Order

NO STOPPING ON SCHOOL ENTRANCE MARKINGS

1. No person shall except upon the direction or with the permission of a police constable in uniform or of a traffic warden cause or permit any vehicle to stop wait or otherwise leave the vehicle in a stationary manner 8:00AM to 9:00AM and 2:30PM to 3:30PM Monday to Friday inclusive in the lengths of roads specified in the Schedule to this Order
2. This Order is made on the 26th day of February 2010 and shall come into effect on the 1st day of March 2010 and may be cited as the "Leeds City Council (Traffic Regulation) (Waiting Restrictions) (No.W31) Order 2008"

**THE COMMON SEAL of
LEEDS CITY COUNCIL**
was hereunto affixed in the presence of:

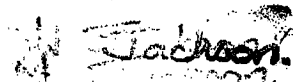

Assistant Chief Executive (Corporate Governance)



**LEEDS CITY COUNCIL
(TRAFFIC REGULATION) (WAITING RESTRICTION)
(NO. W31) ORDER
2008**

**GIPSY LANE BEESTON
LEEDS**

SCHEDULE

**NO STOPPING 8:00AM TO 9:00AM AND 2:30PM TO 3:30PM MONDAY TO FRIDAY INCLUSIVE
ON SCHOOL ENTRANCE MARKINGS**

Lengths of road in Beeston in the Metropolitan District of Leeds

COLUMN 1 NAME OF ROAD	COLUMN 2 LENGTH OF ROAD
Gipsy Lane Beeston LEEDS	EASTERN SIDE - From a point 53 metres south of its junction with the projected southern kerb line of Southleigh Drive, in a southerly direction for a distance of 25 metres.
Gipsy Lane Beeston LEEDS	EASTERN SIDE - From a point 23 metres north of its junction with the projected northern kerblines of The Links, in a northerly direction for a distance of 31 metres.

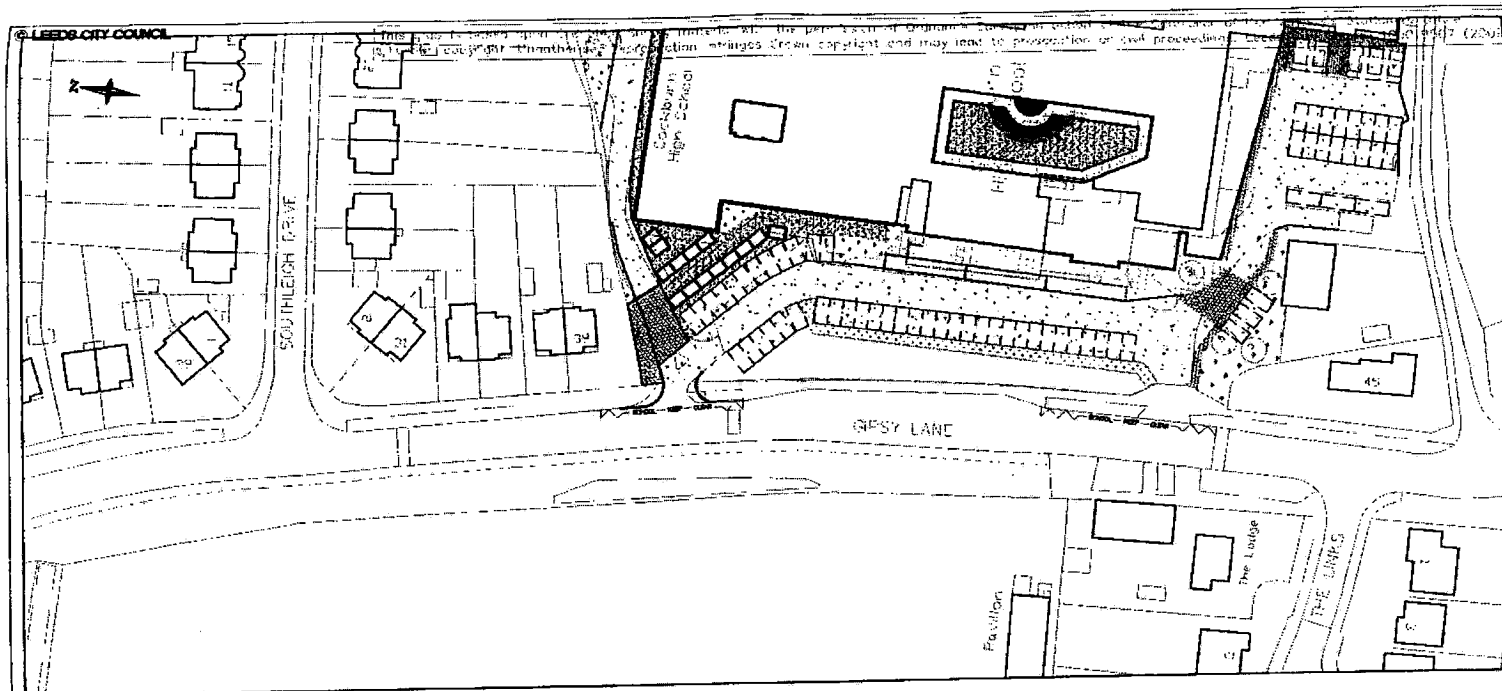

KEY

 No Stopping
 Monday to Friday
 8:00am - 9:00am
 2:30pm - 3:30pm
 on Entrance Markings

COCKBURN HIGH SCHOOL
GIPSY LANE
LCC (TR) (WR) (No W31) ORDER 2008

This drawing is the property of Leeds City Council. It must only be used for the purpose for which it was originally prepared. It must not be copied, published or otherwise used for any purpose other than that for which it was prepared without the express permission of the engineer. Modification or manipulation of all or part of this drawing is strictly prohibited unless specifically requested or approved by the engineer.

INITIALS	DATE	SCALE
DRW: RD	5/08	1:1000
ACAD: RD	5/08	
CHECK: CCB	11/08	REF: PJA 4



DRAWING NUMBER:
HDC2/299041/TR0/01
DATE: November 2009



**LEEDS CITY COUNCIL
(TRAFFIC REGULATION) (WAITING RESTRICTIONS)
(NO.W31) ORDER
2008**

GIPSY LANE BEESTON LEEDS

**NO STOPPING 8:00AM TO 9:00AM AND 2:30PM TO 3:30PM MONDAY TO
FRIDAY INCLUSIVE ON SCHOOL ENTRANCE MARKINGS**

Leeds City Council has made the above Order on 26 February 2010 under the powers contained in the Road Traffic Regulation Act 1984. The effect of the Order which comes into force on the 1 day of March 2010 will be to introduce no stopping on school entrance markings from 8:00am to 9:00am and 2:30pm to 3:30pm Monday to Friday inclusive on sections of the eastern side of Gipsy Lane, Beeston Leeds from a point:-

1. 53 metres south of its junction with Southleigh Drive for a distance of 25 metres in a southerly direction; and
2. 23 metres north of its junction with The Links for a distance of 31 metres in a northerly direction.

A copy of the Order together with a plan showing the affected sections of highway may be examined during normal office hours at the Legal, Licensing & Registration Reception Desk, 1st Floor, St George House, Great George Street, Leeds 1 and at Town Street Library, Beeston, Leeds LS11 8PN.

If you wish to question the validity of the Order or any provision contained in it on the ground that it is not within the powers conferred by the Road Traffic Regulation Act 1984, or on the grounds that any requirement of the Act or an instrument made under the Act has not been complied with in relation to the Order, you may within six weeks from the date upon which the Order was made, apply to the High Court for that purpose.

Dated this 26 day of February 2010

Nicolé Jackson
Assistant Chief Executive (Corporate Governance)
Civic Hall
LEEDS LS1 1UR

