

FOR DISCUSSION PURPOSES ONLY

We want you to have your say on the future of your community so please fill in this form at the consultation event (see the end of this form for other ways that you can comment)

Folly Lane

(Residential development opportunity on a cleared site)

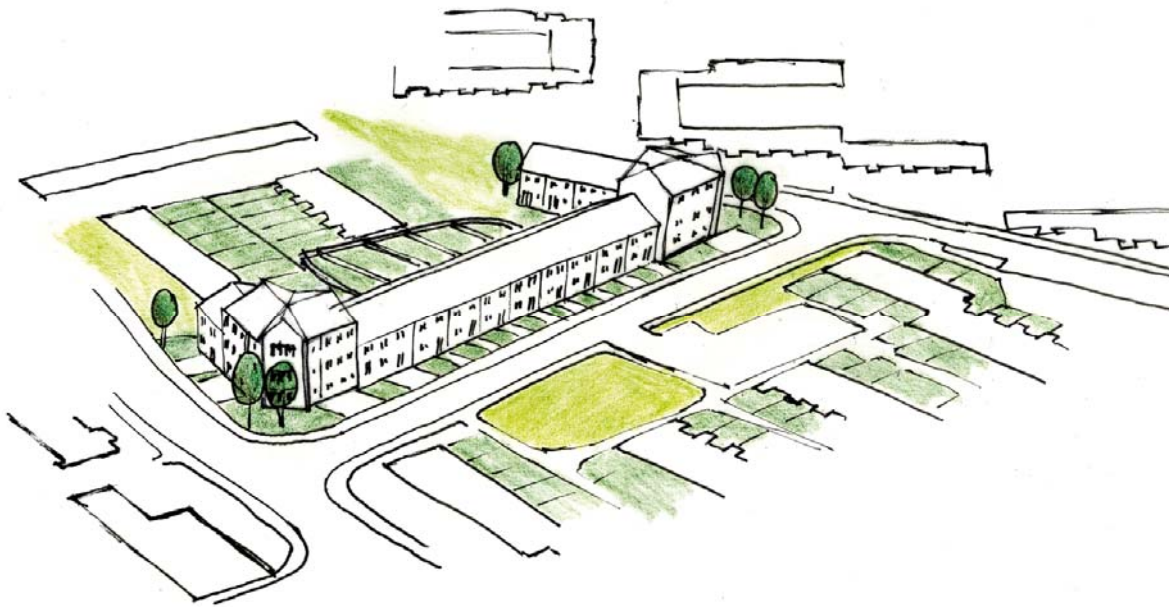

(Indicative only)

What is the 'Preferred Option'?

Development of 33 two storey town houses and apartments

How would the 'preferred option' benefit local people?

- Provision of affordable homes
- Development of an unattractive, cleared site which is a source of anti social behaviour
- Strengthened pedestrian links and public realm
- Creation of private gardens
- Introduction of high quality architecture
- Opportunity to build on 'The Greenhouse' as a catalyst

What do you think of this 'preferred option'?

Agree	Disagree
--------------	-----------------

Any other comments?

--

Please hand this form to one of the facilitators or place in the box at the consultation event. Or alternatively:

Post

Ian Mackay
Renaissance Team
City Development
The Leonardo Building
2 Rossington Street
Leeds
LS2 8HD

Tel: 0113 247 8090

E-mail: ian.mackay@leeds.gov.uk

Website: www.leeds.gov.uk/beestonhillandholbeck

Planning Aid

Seeking independent advice and support

Planning Aid provides free, independent and professional advice on planning issues to community groups and individuals who cannot afford to pay a planning consultant.

Yorkshire Planning Aid can be contacted as follows:

The Green Sand Foundry
99 Water Lane
LS11 5QN

Tel: 0113 237 8486

Email: ykco@planningaid.rtpi.org.uk

Website: www.planningaid.rtpi.org.uk

If you would like to be kept informed on progress on the regeneration plan, please provide your contact details:

We want to make sure that all our services are delivered fairly. We are therefore asking the following questions about you, so that we can make sure that our services include everyone's needs. The information you provide will be kept confidential. You do not have to answer these questions, and if you choose not to, this won't make any difference to the service you receive. **(Please tick the relevant boxes)**

Gender	Male	<input type="checkbox"/>	Female	<input type="checkbox"/>	Age	Under 20	<input type="checkbox"/>
						20-30	<input type="checkbox"/>
Disabled	Yes	<input type="checkbox"/>	No	<input type="checkbox"/>		30-45	<input type="checkbox"/>
Are you disabled?						45-60	<input type="checkbox"/>
						60+	<input type="checkbox"/>

Ethnic Origin - What is your Ethnic Group?

Please choose one section from A - E, and then tick the appropriate box to indicate your ethnic background.

A White

British Irish Any other White background please write below:

B Mixed

White and Black Caribbean White and Black Asian White Asian

Any other mixed background please write below:

C Asian or Asian British

Indian Pakistani Bangladeshi Kashmiri

Any other Asian background please write below:

D Black or Black British

Caribbean African

Any other Black background please write below:

E Other ethnic groups

Chinese Gypsy/traveller

Any other background please write below:

Could you please also state whether you are an asylum seeker or refugee.

Are you an asylum seeker? Yes No

Are you a refugee? Yes No

